

## Samsung "Novus", Wall Mounted Evaporator, Split System

Job Name \_\_\_\_\_  
 Purchaser \_\_\_\_\_  
 Submitted to \_\_\_\_\_  
 Unit Designation \_\_\_\_\_

Location \_\_\_\_\_  
 Engineer \_\_\_\_\_  
 Reference \_\_\_\_\_ Approval \_\_\_\_\_ Construction \_\_\_\_\_  
 Schedule # \_\_\_\_\_

## Specifications

Model	System Model Number		AR12JSFLBWKXCV
	Indoor Unit Model Number		AR12JSFLBWKNCV
	Outdoor Unit Model Number		AR12JSFLBWKXCV
Performance	Nominal Capacity	Cooling / Heating (Btu/h)	12,000 / 12,000
	Capacity Range	Cooling (Btu/h)	5,000 - 14,500
		Heating (Btu/h)	4,200 - 16,500
	SEER / EER		20.0 / 12.8
	COP (nominal heating)		3.38
	HSPF		9.0
		Condensate (pints/hour)	2.49
Power	Voltage	ø / V / Hz	1 / 208-230 / 60
	Working Voltage Range (VAC)		187 - 254
	Operating Current (Low/Std./High)	Cooling (A)	2.7 / 5.0 / 6.4
		Heating (A)	3.0 / 5.2 / 8.3
	Max. Breaker	Amps	15
	Min. Circuit Ampacity (A)		11
Dimensions	W X H X D (inches)	Indoor Unit	35 7/16 X 11 3/32 X 8 29/32
		Outdoor Unit	30 13/16 X 23 13/16 X 11 7/16
	Weight (lbs.)	Indoor Unit	26.5
		Outdoor Unit	77.2
	Condensate Connection		13/16"
Heat Exchanger	Indoor & Outdoor Unit	Type	Aluminum Fin - Copper Tube
		Tube Diameter	9/32
	Indoor Unit		2 row / 15 step
	Outdoor Unit		2 row / 26 step
Sound Pressure Level	Indoor Unit (dB)	Quiet / High	31 / 42
	Outdoor Unit (dB)	High	52
Operating Temperatures (°F)	Outdoor	Cooling	14 ≤ T ≤ 115
		Heating	5 ≤ T ≤ 75
	Indoor	Cooling	62 ≤ T ≤ 90
		Heating	20 ≤ T ≤ 80
Pipe Connections	Indoor & Outdoor	High side (flare)	1/4
		Low side (flare)	3/8
	Maximum / Minimum Line Set Length (ft.)		50 / 9.8
	Maximum Vertical Separation (ft.)		16.4
Refrigerant	Type		R410A
	Control Method		Electronic Expansion Valve
	Factory Charge	oz.	40.56
	Charged for		25'
	Additional Refrigerant		0.22 oz./ft. over 25 ft.
Compressor	Type		BLDC, Inverter Driven, Rotary
	RLA	A	7.5
Evaporator Fan	Type		BLDC motor with cross-flow fan (1)
	Air Volume	CFM (Turbo/H/M/L)	425 / 353 / 282 / 247
	FLA	Amps	0.4
Condenser Fan	Motor		BLDC motor with axial fan (1)
	Air Volume	CFM (max.)	1,342
	FLA	Amps	0.45
Optional Accessories	Condensate Pump	Aspen	ASP-MO-UNIV 110-250
		Blue Diamond	BD-BLUE230
	Wall bracket (for outdoor unit)		CKN-250 or CKN-500
	Line sets - insulated and flared, interconnect cables included		25' - SLS2506
			50' - SLS5006
Safety	Certifications	ETL & ETLc	
	Devices	PCB fuses, indoor unit terminal block thermal fuse, current transformer, over-voltage protection, temperature limit protection logic, compressor overload sensing	
Warranty	7 Years Compressor, 5 Years Parts, 90 Day Limited Labor		



(actual equipment appearance may vary)

## General Information

- Outdoor unit shall provide 208/230V power to indoor unit via 14 AWG X 5 interconnect power cable (4 wire + ground).
- Electro-static, washable, main filter as standard

## Construction

- Indoor unit chassis shall be UL94 V0 with a galvanized steel mounting bracket
- The outdoor unit shall be galvanized steel with a baked on powder coated finish for durability

## Heat Exchanger

- The heat exchanger shall be mechanically bonded fin to copper tube

## Refrigerant System

- The compressor shall be hermetically sealed, inverter controlled, BLDC Rotary
- Refrigerant flow shall be controlled by electronic expansion valve at outdoor unit

## Indoor Fan

- The indoor fan shall be a single, antibacterial cross-flow type
- Three fan speed settings and auto setting
- Automatic (motorized) vertical (up and down) swing louver (1)

## Controls

- Control signal shall be DDC type signal
- Interconnect wiring shall be 14 AWG X 5 wire between outdoor and indoor unit
- Unit shall be operated via wireless controller as standard
- The indoor unit shall ship with a wireless controller and batteries as standard

## Convenience

- Auto restart
- "Turbo Mode" to quickly reach set temperature
- Auto changeover
- 24 hour, single event timer
- Good'sleep mode
- Quiet mode
- Dry mode
- Single event, ON/OFF timer
- Single User Mode to reduce energy consumption during low demand operation
- Auto Clean function to help prevent dust and contaminant buildup on the evaporator coil.
- Temperature display on front of indoor unit.



Unit: inches

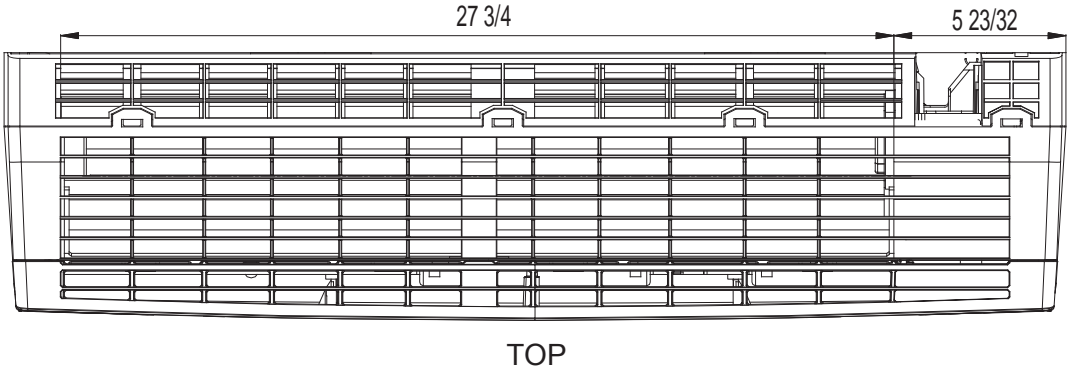
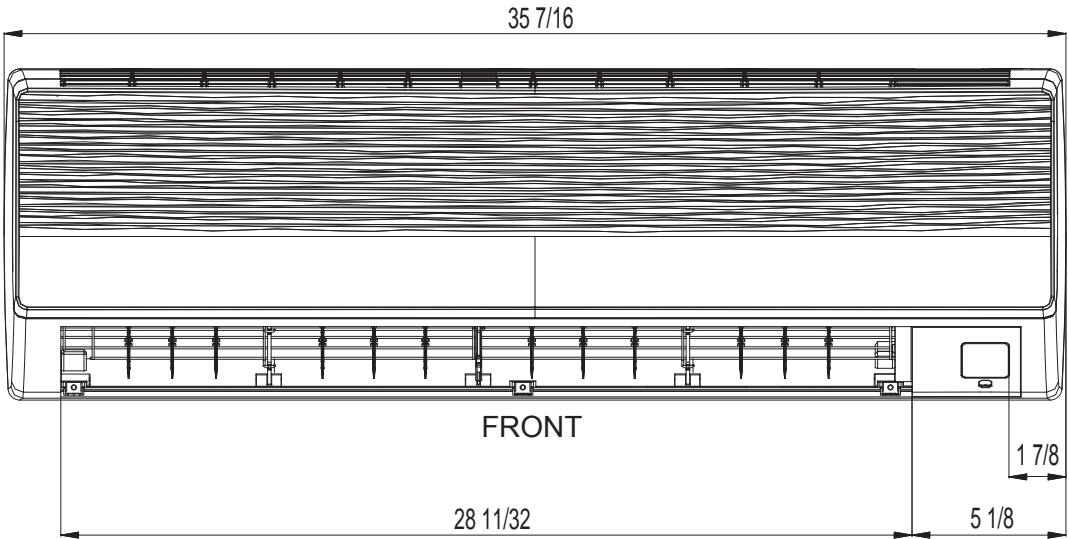
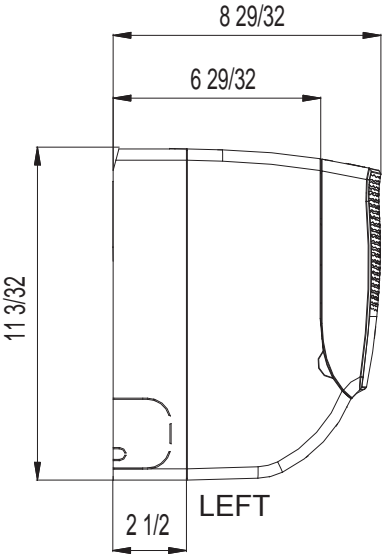

Indoor unit mounting plate

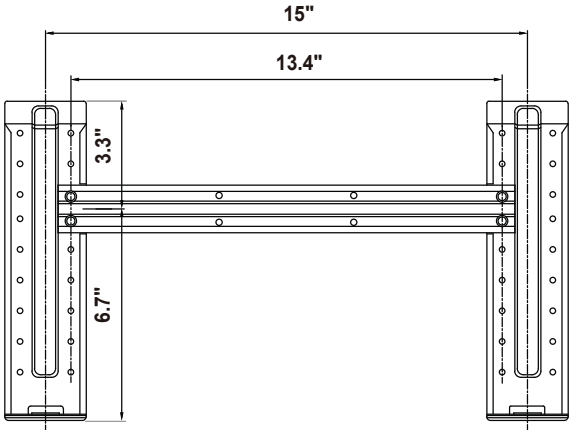

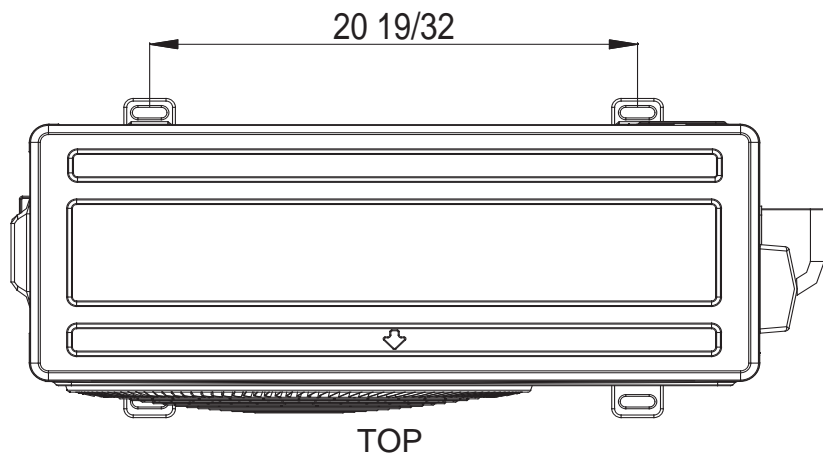
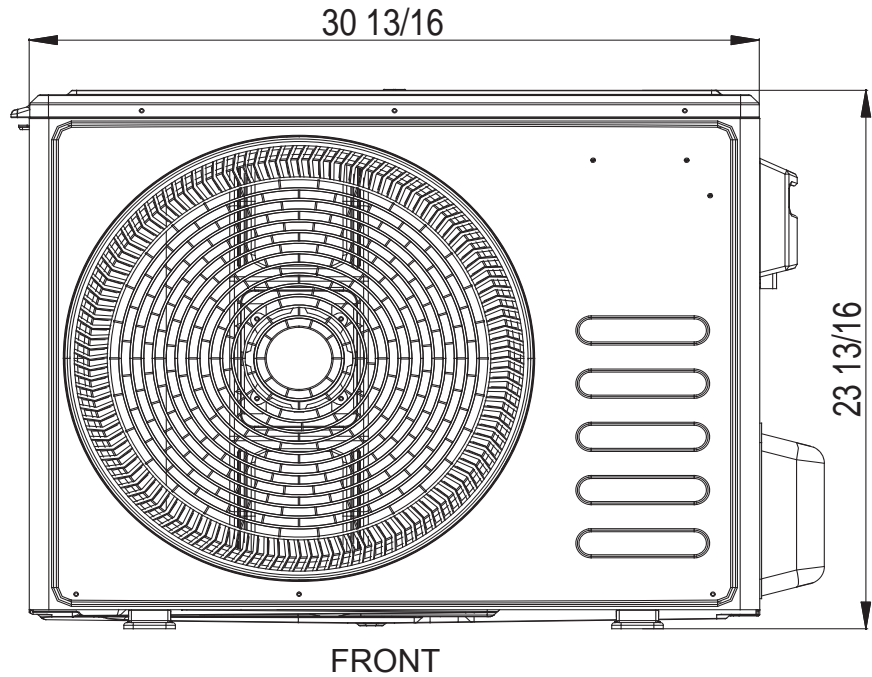
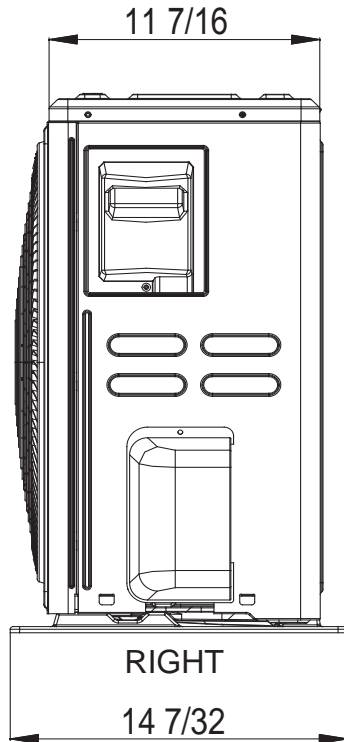

For reference only. Always refer to installation manual for complete details.

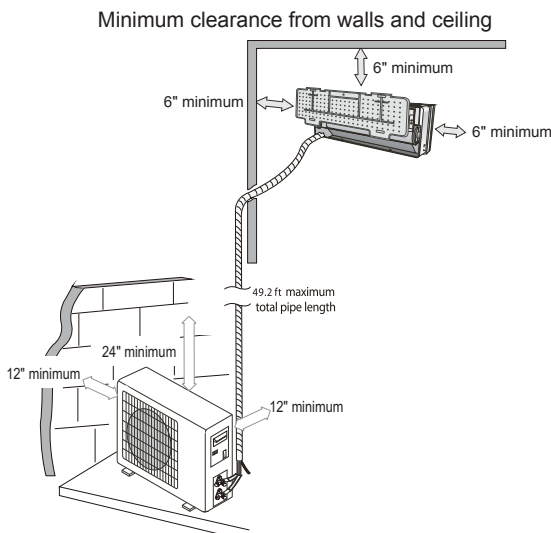

Basic power wiring between indoor and outdoor units (208/230V)

